

Installation Instructions

Mach Toilet Sensor

Record your model number:

录入你的产品型号: _____

Chinese 23-44

KOHLER®

1535726-T2-C

Thank You for Choosing KOHLER

Need help? Contact our Customer Care Center.

- Mainland China: +(86) 800-820-2628, +(86) 400-820-2628
- Hong Kong (China), Macau (China), Taiwan (China): +(852) 3125-7728

Tools and Materials

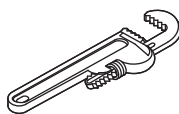
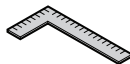
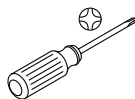
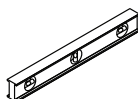
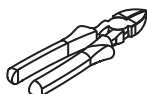

Before You Begin

- Please read these instructions carefully to familiarize yourself with the required tools, materials, and installation sequences. Follow the sections that pertain to your particular installation. This will help you avoid costly mistakes. In addition to proper installation, read all operation and safety instructions.
- All information in these instructions is based upon the latest product information available at the time of publication. Kohler China reserves the right to make changes in product characteristics, packaging, or availability at any time without notice.
- These instructions contain important care, cleaning, and warranty information - **please leave instructions for the consumer.**

Sensor Specifications

Model	K-34176T-**, K-34178T-**, K-34180T-** (4L/5.8L)
	K-34177T-**, K-34179T-**, K-34181T-**(6 L; 8 L)
Power	K-16305T-NA (Input AC 220 V 50/60 Hz, Output DC 6 V)
Liter per flushing	ECO Flushing : 4L (K-34176T-**, K-34178T-**, K-34180T-**)
	Toilet: 5.8L, 6 L, and 8L (According to requests from different SKUs)
Temperature	Environmental temperature: 1~55°C
	Water temperature:1 ~45°C
Starting pressure	0.1~0.86 MPa
Sensing distance	Within 80±5 cm from sensing window
Flushing delay	about 3~5 seconds after user leaves
Connect dimension	Inlet pipe G1", Outlet pipe G1-1/2"
Protective flushing	Auto flush once every 24 hrs if unused
Recommended working pressure	0.24~0.55 Mpa

Note

1. The sensing distance in the table is measured with a 30x30 cm² white or black board as the reflecting surface.
2. The user may set the amount of water per flush according to the specifications of the specific toilet and water pressure.
3. To ensure an effective flushing preformance, please turn the adjusting bolt properly according to actual using conditions when the product is used with toilet (such as K-8750, etc.).
4. Do not discard the special wrench when the installation is complete. It will be required to repair the outlet connection assembly and the vacuum breaker to perform maintenance.
5. The slurry mold is used only when installing the valve box.
6. The product will work after 2 minutes after switching ON, as the product will take time to detect the surrounding.

7. Adjustment of Flush Volume

When the water pressure is 0.10 MPa ~ 0.55 MPa, it may cause splashes. To reduce the splashing, reduce the water flow. When adjusting, remove the sensor cover and turn the adjusting bolt for water flow until there is good flush and no splashing is seen.

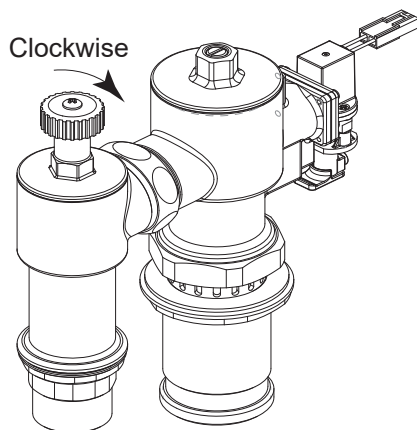

Rough-In

Unit: mm

Floor-mount Toilet Location 1

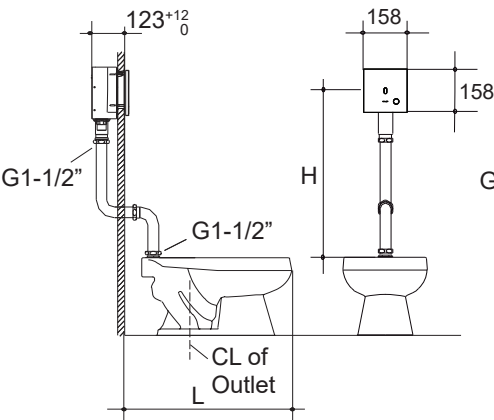

Floor-mount Toilet Location 2

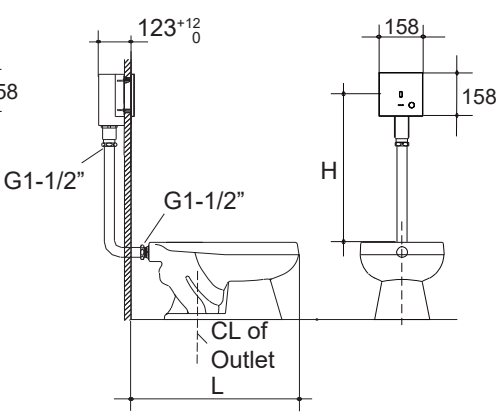
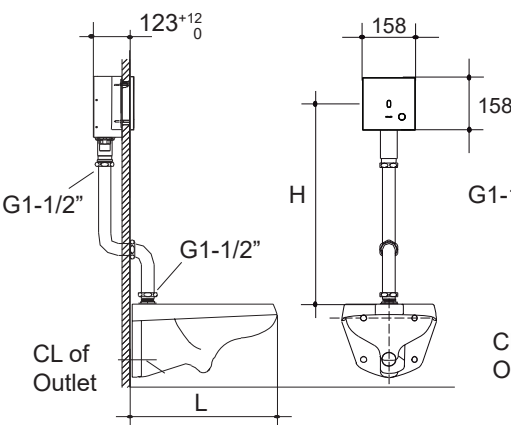

Table of installation positions for toilets

L	$700 < L \leq 730$	$730 < L \leq 760$	$760 < L \leq 790$	$790 < L \leq 820$	$820 < L \leq 850$
H	$640 < H \leq 670$	$670 < H \leq 700$	$700 < H \leq 730$	$730 < H \leq 760$	$760 < H \leq 790$

Wall-mount Toilet Location 1



Wall-mount Toilet Location 2

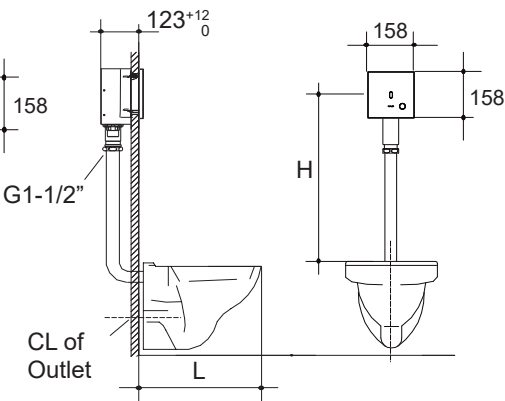

Table of installation positions for toilets

L	$540 < L \leq 570$	$570 < L \leq 600$	$600 < L \leq 630$	$630 < L \leq 660$	$660 < L \leq 700$
H	$570 < H \leq 600$	$600 < H \leq 630$	$630 < H \leq 660$	$670 < H \leq 700$	$700 < H \leq 740$

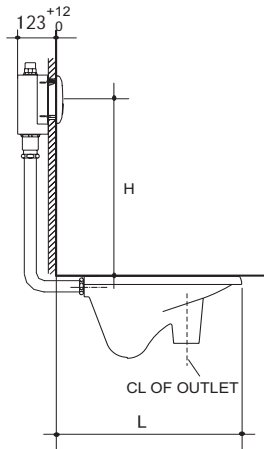

Table of installation positions for squats

L	$700 < L \leq 730$	$730 < L \leq 760$	$760 < L \leq 790$	$790 < L \leq 820$	$820 < L \leq 850$
H	$640 < H \leq 670$	$670 < H \leq 700$	$700 < H \leq 730$	$730 < H \leq 760$	$760 < H \leq 790$

Note

- 1. To ensure the sensing effect, the dimensions for L&H should be strictly followed.
- 2. Do not use the dimension of L and H other than the values in the table.
- 3. When toilet length is in between 540mm and 850mm, use 2430T-NA as top inlet, and 2429T-NA as rear inlet. When squat, please use 2429T-SA-NA as rear inlet.
- 4. To comply with the values in the above tables, you may cut either end of the connecting pipe.

Installation Instructions

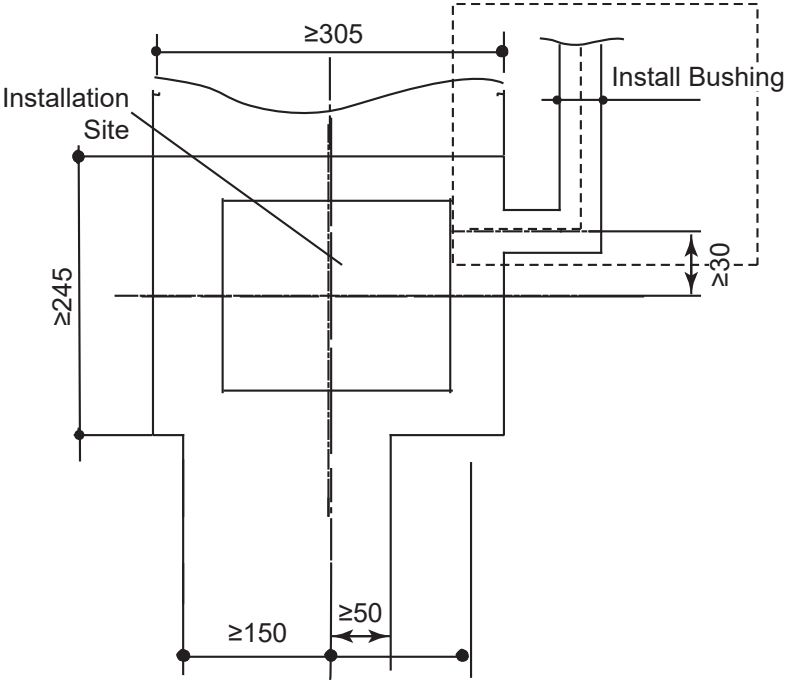

1. Determine the installation location as per the rough-in dimensions and the table of installation position. Chisel out a slot and install the supply tubes. Then flush the supply tubes. The depth of the slot should not be less than 110 mm, see the figure above for rough-in dimension requirement. While installing Mach toilet sensor (like K-34176T), chisel out the slot indicated by the dot line area in the figure above for installation of bushing.

Note

- Installation that fails to comply with the installation position or rough-in dimensions may result in faulty operations or no operations.
- No light shall enter or be reflected onto the sensing window.
- No reflectible objects shall be placed in front of the sensing window (e.g., mirror, polishing stainless steel and some other polished plates).
- No strong ultraviolet radiation or electromagnetic field source should be placed near to the sensor sensing area.

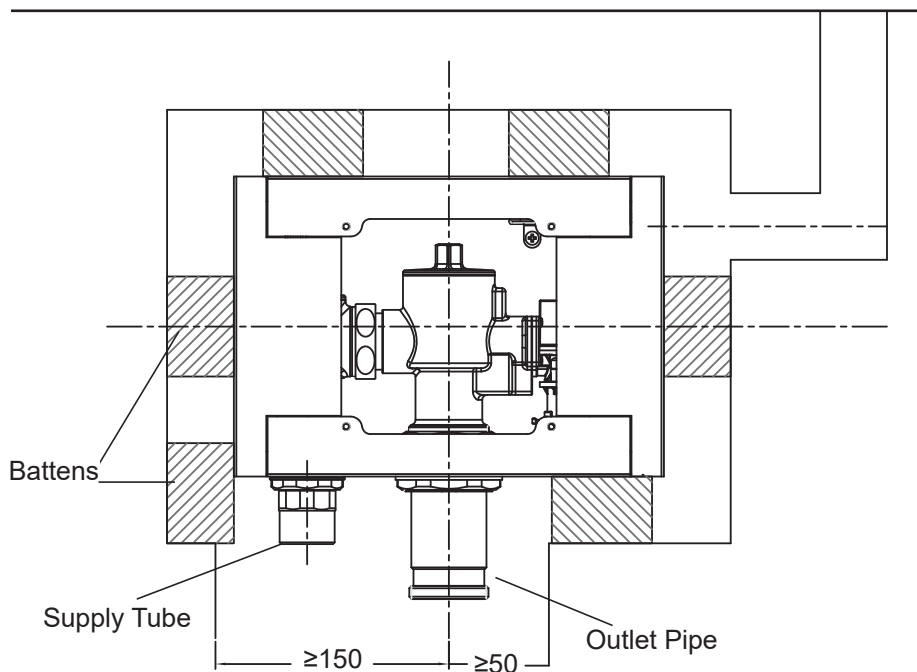

2. Remove the dust-proof cover from the inlet connection of the flushing valve. Then place the flushing valve into the slot, adjust its level and square with battens and connect the inlet tubes. Screw down the nut at the outlet position. Refer to the specific rough-in of different toilets for the connection of outlet fittings.

Note

- Clean the inside of water supply pipe before connecting it to the product.
- Since the installation position of the sensor will affect directly the future operation of the sensor, it is recommended to confirm the correct position of the sensor after its placement and fix it if found misaligned.
- Make sure the direction of inlet and outlet is correct.
- Do not drop the O-rings.
- Keep the wire plug-in away from water.
- Align the center of the flushing valve with the center of the toilets, and ensure it is parallel with the wall else it will result in the false operation of the sensor.
- Do not use any sealant or grease on the valve or connector and outlet pipe.
- When installing more than 3 sets of sensors in one lavatory, the inner diameter of main inlet pipe should be more than 38mm.

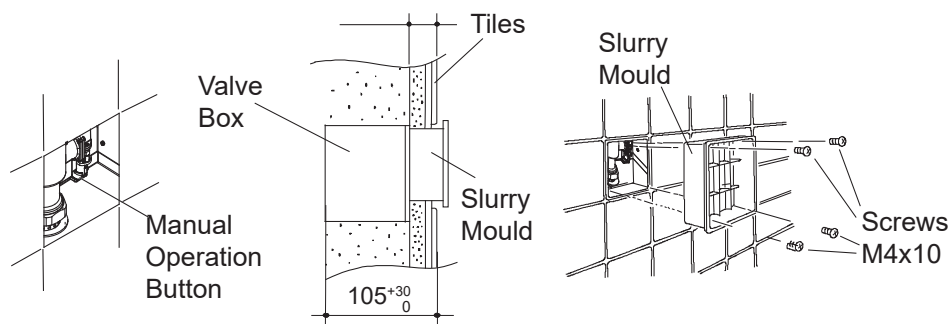

3. Operate the flushing unit with manual operation button. Confirm that there is no leakage after the connecting to supply tube. Revert the manual operation button to its original position. Mount the slurry mold onto the valve box with the help of screws. Apply slurry into the crevice around the valve box and smoothen the surface. Fix the tiles.

Note

- Make sure the outlet connection is completed and no leakage is found before connecting the water supply.
- Make sure the manual lever line is kept safe during this procedure.
- Avoid the plug-ins from wetting, or this will result in false operations of the sensor.

4. After the slurry solidifies, remove the short screws and remove the slurry mould. Connect the solenoid wire and the AC power inlet wire to the respective wires in the faceplate.

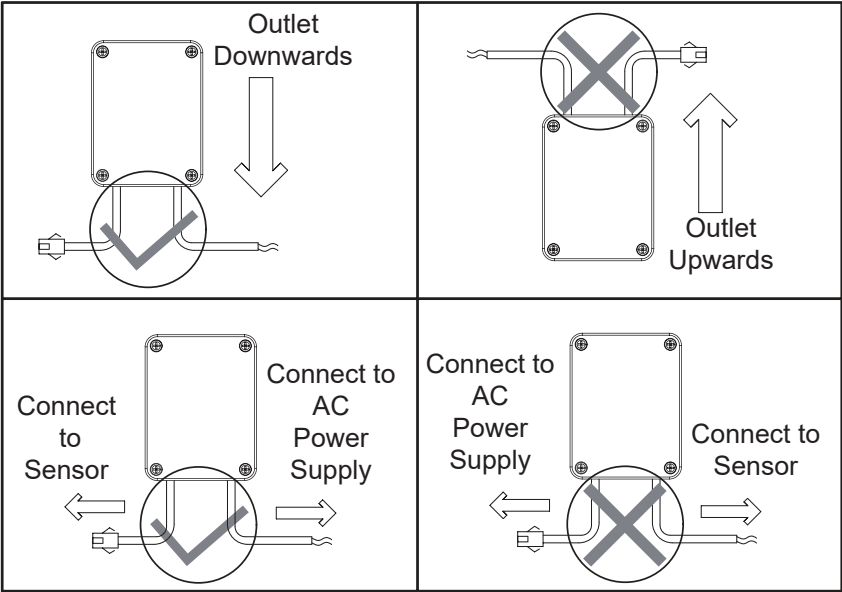

Caution

- Outlet of AC power unit should always be in downward direction.
 - Do not damage the cover of AC power unit or remove the screws to prevent leakage.
5. Connect the K-16305T-NA AC power unit. The way of installation is as shown in the figure above.
- Note:** AC power unit K-16305T-NA is not supplied with the product and needs to be purchased separately.

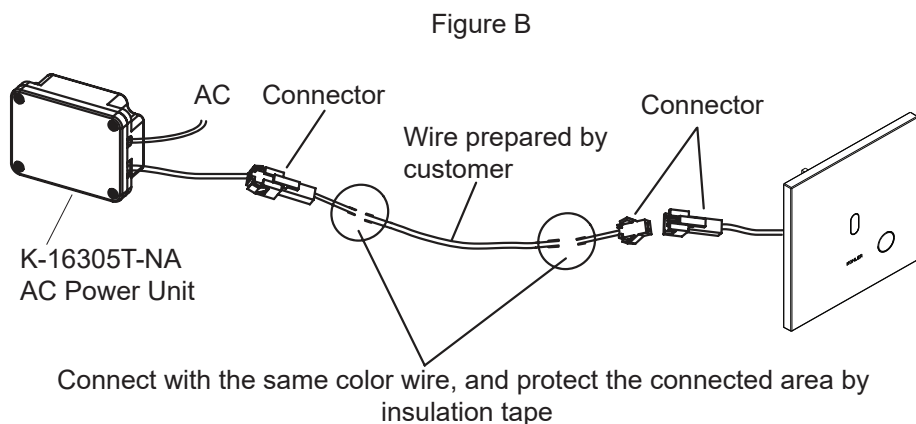
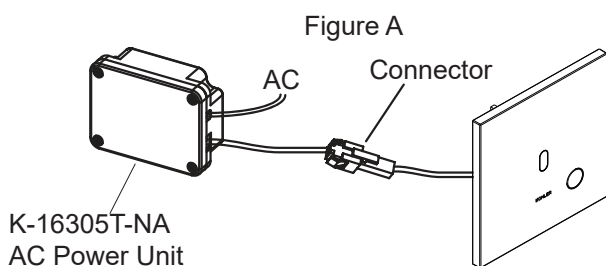

6. Connect the AC power unit to the electric control box. AC power unit is directly connected to electric control box (refer to figure A) or it is connected to electric control box by a connection wire (refer to figure B).

Note

- Keep the connector away from water.
- Make sure the direction of inlet and outlet is correct.
- Do not connect to power supply while installing. Connection line is not supplied. AC connection wire with insulating sleeving is recommended. Wire with nominal section area of conductor which is not less than 0.5mm^2 is recommended. It is cut according to installation requirements (The length of cut wire is recommended less than 10m).
- The head of AC power supply must be protected with appropriate fuse.
- Make sure the AC power supply and water supply is shut off before working with products which are AC power related.

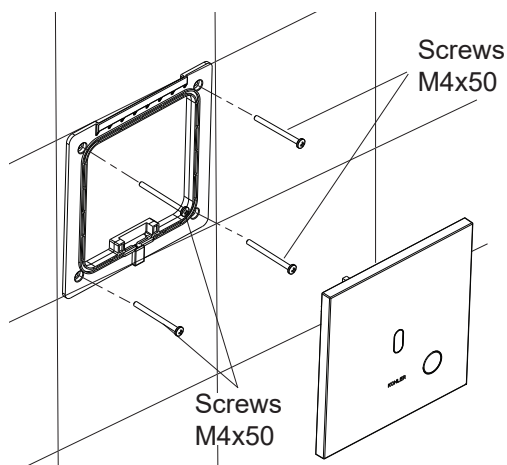

7. Loosen the panel and the fixed plate, then lock with the fixed plate with long screws separately.

Note: The panel and the fixed plate are pre-latched by default. Please refer to how to remove the faceplate in the Maintenance section.

8. After installing the sensor cover, observe the cover if it is upright and its centerline is aligned with that of the toilet. If any deviation occurs, remove the cover and loosen the locking screws of the fixed bracket. Adjust the fixed bracket for correctness. Fasten the screws and reinstall the sensor cover after any adjustment.

Note: The central position and correctness of the sensor will affect the proper operation of the sensor.

Installation in Other Methods

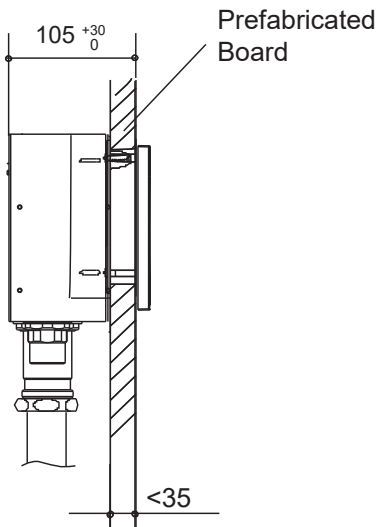

Installation on Prefabricated Board

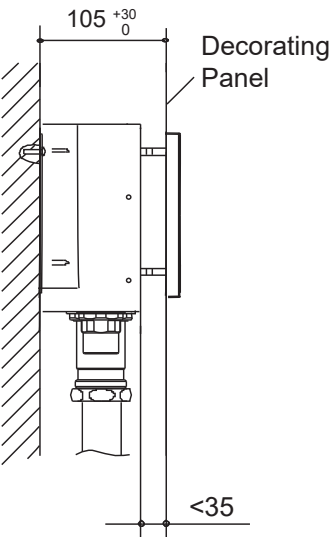

Installation on Decorating Panel

Note: For these two installation forms, the sensor must be installed according to rough-in.

User Guide

Automatic Adjustment of Sensing Distance

Note: The accuracy with which the steps in this section are performed determines the product performance.

The sensing distance of this product is set at within 80 ± 5 cm away from the sensing window along the direction of transmitting angle (with a 30 cm x 30 cm white board as the reflecting surface) in the factory. When the power is applied, the product in ON status automatically adjusts the sensing distance within first 2 minutes of operation. Make sure that all the connections are completed before switching the sensor and proceeding with calibration of sensing distance.

Preparation

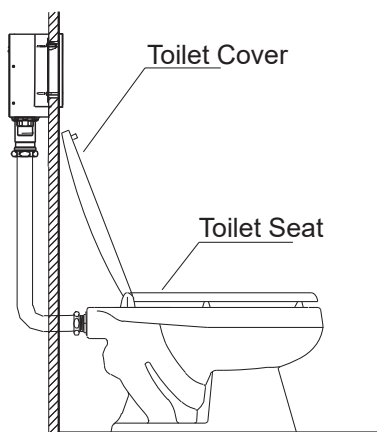

- Pull down the toilet seat. If there is a cover, please lift it as shown in picture above.
 - Remove any unwanted materials near the toilet bowl.
-

Procedures (Complete the steps within 5 mins)

- Remove the sensor cover. Connect AC power unit to control box, and then power it on.
- Install the sensor cover.
- Close the door of the toilet.
- Wait for 2 minutes, until the auto adjustment of sensing distance is complete.

Note

- i. After finishing these steps, the toilet sensor is ready for use.
 - ii. The sensor cover installing must be finished within 5 minutes after power on. If this is not accomplished within 5 minutes, shut off the power. When the indicator stops flashing, power on again and repeat the above steps.
-

Setup of Flushing Volume

Clear the sensing area free of objects in front of sensor window before powering on.

The product will work after 2 minutes after switching ON, as the product will take time to detect the surrounding. There should be no obstacles in front of faceplate in the sensing area during the detecting process which lasts for 2 minutes.

After the product is turned ON within the first 30 seconds, flushing volume setting has to be done. If no flush setting is done, the product will select the default setting as the operation setting.

To set the flush volume

1. Put the control stick close to right side of sensor housing within 30 seconds after powering on.
2. The indicator light on the faceplate blinks once for flushing volume setting 1 and twice in case of flushing volume setting 2. Remove the stick quickly once the light has blinked twice to set the flushing volume.

Note

- If the stick is kept more than 30 seconds without selecting the flushing volume, the product will select the default setting.
- The settings will be preserved after powering off.

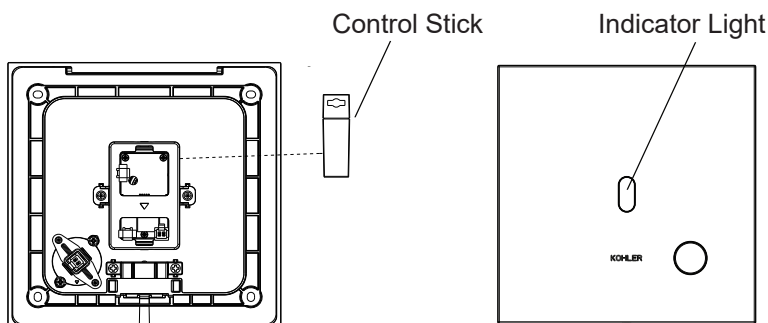

SKU	Flow Volume Setting 1	Flow Volume Setting 2	Flow Volume Setting 3
K-34176T-**	ECO Flush: 4 L Toilet Flush: 5.8L	NA	NA
K-34177T-**	Toilet Flush: 6 L	Toilet Flush: 8 L	NA
K-34178T-**	ECO Flush: 4 L Toilet Flush: 5.8L	NA	NA
K-34179T-**	Toilet Flush: 6 L	Toilet Flush: 8 L	NA
K-34180T-**	ECO Flush: 4 L Toilet Flush: 5.8L	NA	NA
K-34181T-**	Toilet Flush: 6 L	Toilet Flush: 8 L	NA

Note: Flow volume setting 3 is for special use under lower water pressure hence is not defined for certain flushing volume.

Manual Flushing

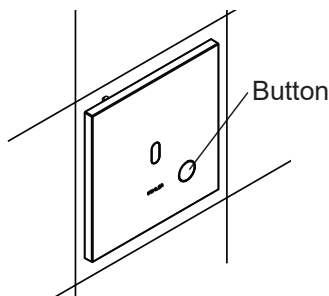

This product can have a good sensing effect towards most of the clothes. However, it may have abnormal sensing to a very small number of clothes. If this occurs, use the mode of manual flushing.

Note

- The button is a standby device that will be used only when the sensor cannot perform correctly or the toilet is being repaired. It is not recommended to use when the sensor is functioning normally.
- When the sensor cannot function properly, please refer to the list of troubleshooting.
- Do not exert too much force to avoid damaging the manual unit.

Protective Flushing

When the toilet has not been used for a long time, the sensor will drive the solenoid valve to flush every 24 hours to avoid the deodorizer and the sewer pipe from drying up.

Maintenance

Toilet Repair

When repairing, you do not have to dismount the sensor. Cover the sensing window with the tape and work with ease.

Note: Do not use adhesive tape with strong adhesive. The mark left by strong adhesive will be very hard to remove and may result in false operation of sensor.

Remove the Faceplate

1. Insert the wrench to push and unlock the latch.
2. Holding the wrench, turn the bottom edge of the faceplate by 5~10 degree away from the wall. Remove the wrench.
3. Lift the faceplate up to remove it.

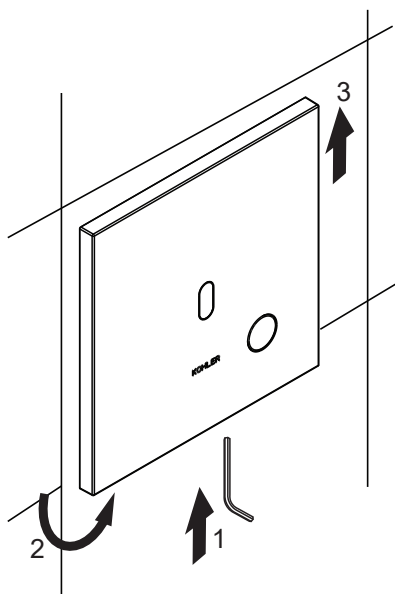

Clean the Filter Screen

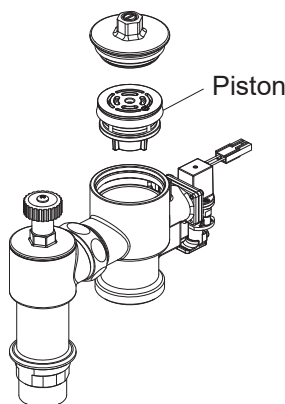

If the flushing volume declines sharply after installation or when used for a long time with no drop in available water pressure, the filter needs to be cleaned. Turn off the fixed cap with a monkey wrench, take out the piston, clean with a brush and reinstall it.

Note

- Turn off the water supply or tighten the adjusting bolt before cleaning.
- Carefully take out the filter when cleaning to avoid foreign materials entering the inside of the valve body.

Care and Clean

Keep the sensing window clean. Wipe with soft cloth and mild cleaner.

Note

- Do not use dust-removing powder, abrasive powder or cleaner containing oil, acid or alkaline ingredient.
- Do not spray air-refresher, disinfectant, or other deodorizing, cleaning solvent directly into the sensing window.
- Keep wire away from water.
- Do not harm the sensor window.

Troubleshooting

Please make following checks before repair:

Symptoms	Probable Causes	Corrective Actions
No flushing (Indicator does not flash)	<ol style="list-style-type: none">1. No power or faulty connection.2. There is an object within the sensing distance.3. The sensing window needs cleaning.4. The toilet seat is loose.5. The toilet cover (if applicable) is closed.	<ol style="list-style-type: none">1. Check the power connection.2. Remove the object or reduce the sensing distance.3. Clean the window.4. Fasten the toilet seat, and follow the steps for automatic adjustment of the sensing distance again.5. Open the toilet cover.
No flushing or poor flushing while the indicator flashes correctly	<ol style="list-style-type: none">1. Adjusting bolt is not fully open.2. Low water pressure.3. Filter is obstructed.	<ol style="list-style-type: none">1. Open the adjusting bolt.2. Improve the water supply.3. Clean the filter.
Flushing but the indicator does not flash	<ol style="list-style-type: none">1. There is dirt inside the valve body.2. The manual unit is damaged.	<ol style="list-style-type: none">1. After cleaning the filter, activate the sensor several times.2. Check the manual unit.
No flushing (Indicator light flashes)	Poor or faulty connection between the AC power unit and the product.	Make sure the connection between the AC power unit and the product is correct.

If the trouble remains after above-mentioned actions are taken, please contact us via distributor.

Important Consumer Information

Consumer Responsibilities

1. Do not attack the sensor.
2. Do not directly flush the sensor with water. The sensor is an electronic instrument.
3. Do not let sunlight or other light source enter or be reflected into Sensor Window.
4. Do not hang on the opposite wall any reflective items or install light/electronic sensor such as toilet flushing sensor.
5. Do not make Sensor Window near strong ultraviolet or electromagnetic field.
6. Keep the sensor window clean. The sensor cover can be cleaned by soft rag with neutral liquid detergent. Do not use eradicator, abrasive powder or oil, acid or alkali liquid detergent. Do not spray air freshener, disinfectant or other kinds of odious removing, cleaning organic liquid to the sensor directly.
7. Urinal is designed for use with potable water. Avoid water that includes a lot of contaminants or acid/alkali water and impure water.
8. When AC power unit is connected to 220V AC power supply, corresponding protective measures should be taken.
9. Please confirm no water penetration at the connection area of AC wire, and the connection area is not easy to be affected by damp.
10. Do not connect power unit to AC power supply until the sensor installation is finished.
11. The head AC power supply must be protected with appropriate fuse.
12. Please confirm the AC power supply and water supply should be shut off before maintaining the products with AC power related.
13. All electrical connection must be in compliance with related regulation and codes.
14. All installation staff should be well familiar with installation instruction.

Content of Hazardous Substances in Product

Reclaim Indication

When the product exceeds service life or is unable to use after repair, do not throw the product away in the normal trash. Please dispose the waste electronic parts through a qualified reclamation enterprise. Make sure the product is handled properly. Disposing of product must be done in accordance with the local or national government law.

Statistics of Contents of Toxic or Hazardous Substances or Elements

Part name	Toxic or Hazardous Substance or Elements					
	Lead (Pb)	Mercury (Hg)	Cadmium (Cd)	Hexavalent Chromium (Cr(VI))	Polybrominated biphenyls (PBB)	Polybrominated Diphenyl Ethers (PBDE)
Cover Assy.	X	○	○	○	○	○
Valve Assy.	X	○	○	○	○	○
Control Box Assy.	X	○	○	○	○	○
*Battery Box Assy.	○	○	○	○	○	○
*Battery	○	○	○	○	○	○
*AC Power Box	○	○	○	○	○	○
*Water Inlet Assy.	X	○	○	○	○	○
Accessories	○	○	○	○	○	○

This form is prepared in accordance with SJ/T 11364.

- Indicates that the substance in the material composition is below the high limits of the current requirements in GB/T26572.
- X Indicates that at least one of the homogeneous substance in the material composition is below the high limits of the current requirements in GB/T 26572.
- * Indicates only partial product series contains this substance.

Note: The information provided is based on the supplier data and Kohler inspection results. The product is designed not to hurt the environment. Under current technology, all hazardous materials have been used in the smallest amounts possible. Kohler will strive to reduce the use of these hazardous materials used in this product.



The product “service life for environment protection” is 10 years; Kohler Company will specify product service life based on product characteristics. The product “service life for environment protection” is only effective when the product is used as described in the product specification.

安装说明书

迈锐大便感应冲洗器

感谢您选择科勒

科勒（中国）投资有限公司
中国上海市静安区江场三路158号 邮编：200436
制造商：上海科勒电子科技有限公司
中国上海宝山区丰翔路1955号 邮编：200444

所需工具及材料

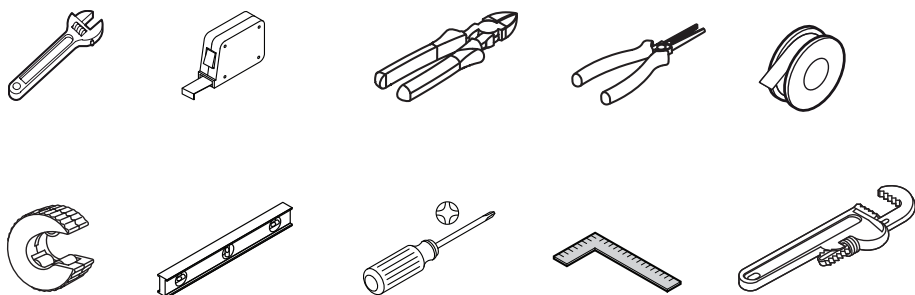

安装之前

- 请仔细阅读本说明书，以便熟悉所需工具、材料及安装顺序。请遵照相关章节进行安装，以避免由于安装不当而造成不必要的损失。除了有关正确的安装方法之外，请务必阅读所有操作及安全说明。
- 本说明书中所有的资料是按最新出版的产品资料编写而成。科勒中国公司保留任何时候更改产品特性、包装或产品可供类型的权利。
- 本说明书包含保养、清洁及质保相关信息，请把这些资料交给用户阅读。

感应器规格

型号	K-34176T-**, K-34178T-**, K-34180T-** (4L/5.8L)
	K-34177T-**, K-34179T-**, K-34181T-**(6 L; 8 L)
电源	K-16305T-NA (输入AC 220 V 50/60 Hz; 输出DC 6 V)
冲洗水量	节水冲水：4L (K-34176T-**, K-34178T-**, K-34180T-**)
	普通冲水：5.8L, 6 L, 8L (不同产品型号有所差异)
使用温度	环境温度：1℃～55℃
	水温：1℃～45℃
启动压力	0.1～0.86 MPa
感应范围	距感应窗口80±5cm以内
冲洗延时	人离开后约3秒～5秒
连接尺寸	进水管G1", 出水管G1-1/2"
设备保护冲洗	无人使用时每24小时自动冲洗一次
建议工作压力	0.24～0.55 MPa

注意

- 表中感应范围距离的测定是以30cmx30cm白纸为反射平面。
- 用户可以根据便器的冲洗规格以及水压设定冲水量。
- 为保证冲洗效果，当配便器（如 K-8750等）时，需根据实际使用情况，适度调节水量调节栓。
- 专用扳手在安装完毕后请勿丢弃，以供专业维修人员在维护出水连接组件和真空破坏器时使用。
- 灰浆模仅在安装暗盒时使用。
- 由于需要时间感应周围环境，产品上电2分钟后方可达到正常工作状态。

7. 水流调节

流动水压在0.10~0.55 MPa时，如有溅出现象可适当调小水流速度。调节时取下面板，顺时针方向旋动水流调节栓直至能冲洗干净而又不溅出即可。

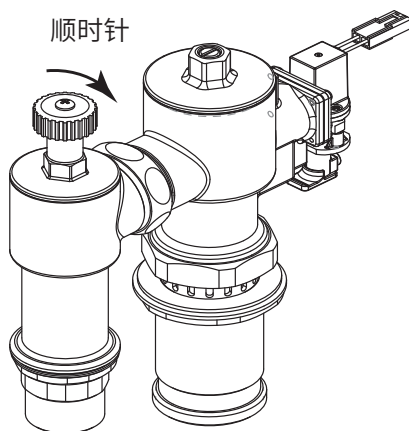

尺寸图

单位:毫米

落地座便器安装示意1

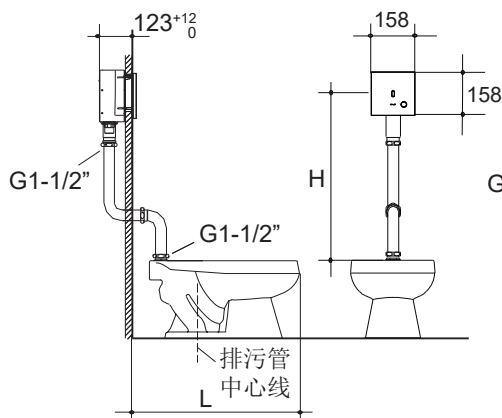

落地座便器安装示意2

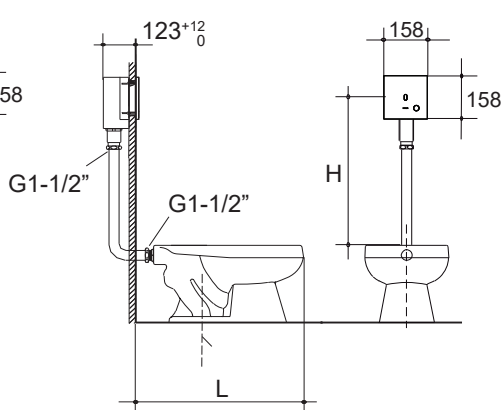

座便器安装位置

L	$700 < L \leq 730$	$730 < L \leq 760$	$760 < L \leq 790$	$790 < L \leq 820$	$820 < L \leq 850$
H	$640 < H \leq 670$	$670 < H \leq 700$	$700 < H \leq 730$	$730 < H \leq 760$	$760 < H \leq 790$

挂墙座便器安装示意1

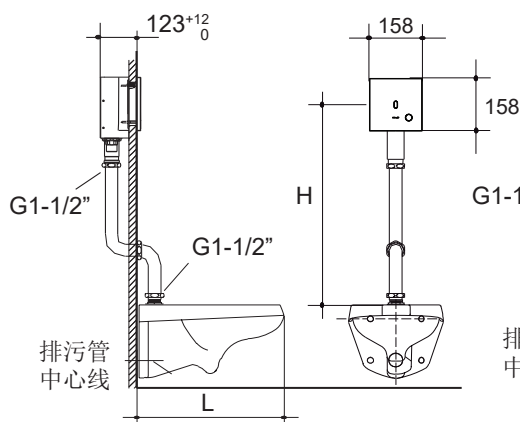

挂墙座便器安装示意2

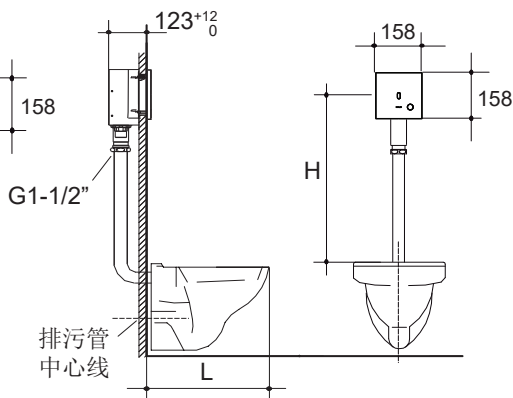

座便器安装位置

L	$540 < L \leq 570$	$570 < L \leq 600$	$600 < L \leq 630$	$630 < L \leq 660$	$660 < L \leq 700$
H	$570 < H \leq 600$	$600 < H \leq 630$	$630 < H \leq 660$	$670 < H \leq 700$	$700 < H \leq 740$

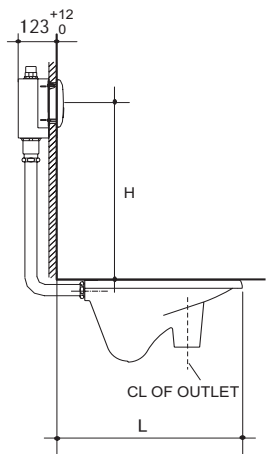

蹲便器安装位置

L	$700 < L \leq 730$	$730 < L \leq 760$	$760 < L \leq 790$	$790 < L \leq 820$	$820 < L \leq 850$
H	$640 < H \leq 670$	$670 < H \leq 700$	$700 < H \leq 730$	$730 < H \leq 760$	$760 < H \leq 790$

注意

- 为保证感应效果，L、H安装对应尺寸需严格遵守。
- 若L、H值不在表格范围内，不推荐使用。
- 当座便器安装长度 $540 < L < 850$ 时，上进水配管请选配2430T-NA, 后进水配管请选配2429T-NA。当配蹲便器时，使用2429T-SA-NA后进水配管。
- 为满足以上表中的尺寸要求，配管两端均可按需求锯短。

安装步骤

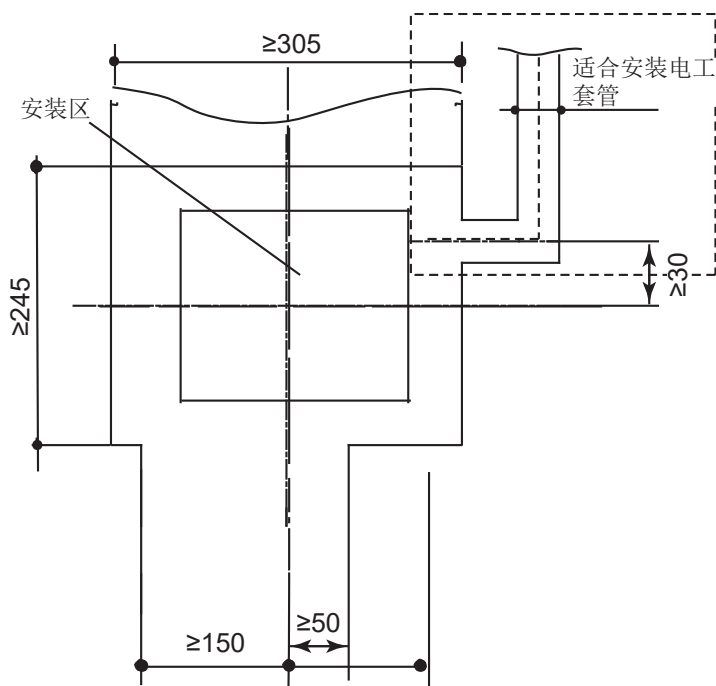

1. 根据安装尺寸图及安装位置表确定安装位置，凿出槽坑，埋设供水管，并冲洗供水管道。槽深不小于110 mm。安装迈锐便器冲洗阀(如 K-34176T)时，凿出图示虚线区域内的槽坑，以用于安装电工套管。

注意

- 未按安装位置表及规定尺寸安装可能引起误操作或不感应情况发生。
- 避免光源直射或反射进入感应窗口。
- 请勿在感应窗口前放置易反射物品（如镜子、光亮不锈钢板及其它镜面物体等）。
- 不能靠近强烈紫外线或电磁场。

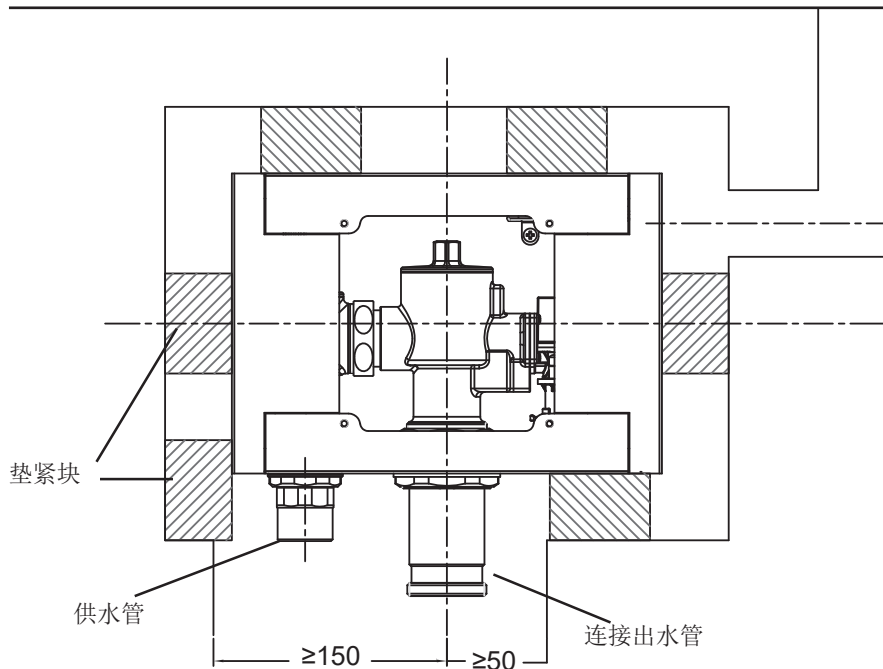

2. 将冲洗阀进水连接的防尘罩取下。然后将冲洗阀放入槽坑内，用垫紧块将其固定平整、端正，接好进水管。拧紧出水处的螺母。出水配管的连接根据座/蹲便器的不同按安装尺寸图所示方式安装。

注意

- 将本产品连接供水管前，请先冲洗干净供水管。
- 感应器的安装位置将对感应器工作产生直接影响，因此需确认感应器位置准确无误后再固定。
- 请确保进出水方向正确。
- 请勿将密封圈丢弃。
- 避免接插件受潮。
- 请将冲洗阀中心线与座/蹲便器中心线对齐，并确保与墙面平行，否则将可能引起误操作。
- 请勿在阀体部件或接头和出水配管上使用任何密封胶或油脂。
- 同一个卫生间安装3个或以上感应冲水阀时，主进水管内径需超过38mm。

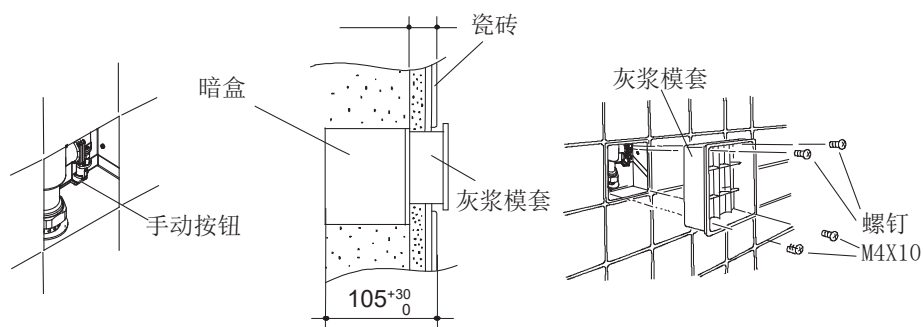

3. 用手动按钮组件驱动冲洗器, 试通水, 确认各管道连接处无渗漏后, 将手动拉线组件放回原位。将灰浆模装于阀盒上, 阀盒周围空隙用灰浆抹平。

注意

- 试水过程中, 确保出水口连接完成且无渗漏。
- 在安装过程中, 确保手动按钮在安全状态即正常关闭状态。
- 防止接插件受潮, 否则将引起感应器误操作。

4. 灰浆固化后，取下短螺钉，揭去灰浆模，将面板组件的电磁阀线束，交流电源盒线束与面板组件上相应线束相连接。

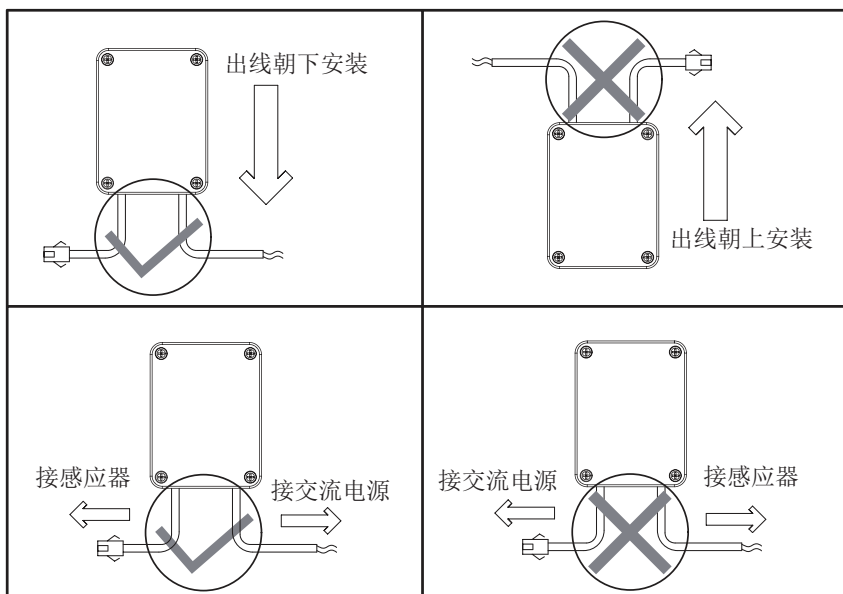

注意

- 交流电源盒出线应始终朝下安装。
- 安装时严禁损伤交流电源盒外壳或移开电源盒盖螺钉，以防止漏电。

5. 连接K-16305T-NA交流电源盒。安装方式如下图所示。

注意:交流电源盒K-16305T-NA 不随产品提供，需要单独购买。

图 A



图 B



6. 将交流电源盒与电控盒相连。交流电源盒与电控盒直接相连（参见图 A）或通过连接线与电控盒相连（参见图 B）。

注意

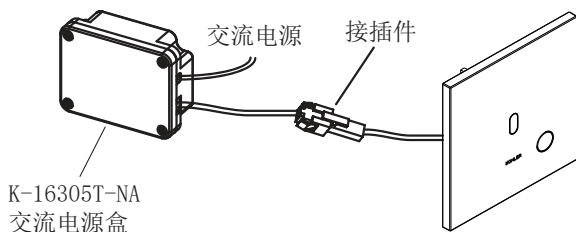
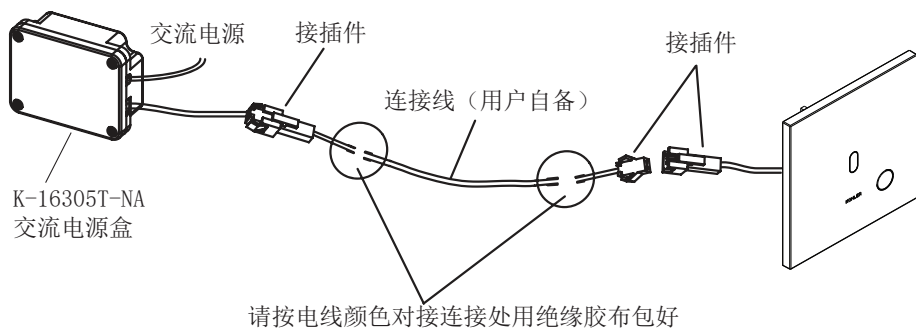
- 不要让电线接插件接触水。
- 确保进出水方向正确。
- 安装时不要向电源盒供电。连接线请用户自备，建议交流电源线采用导体标称截面积 $\geq 0.5\text{mm}^2$ 的绝缘套管电线，电线长度根据实际安装需要自行裁剪（建议连接线路长度小于10m）。
- 交流电的总电源必须有合适的熔断丝加以保护。
- 准备使用交流电相关的产品前，请确保断开交流电源并关闭水源。

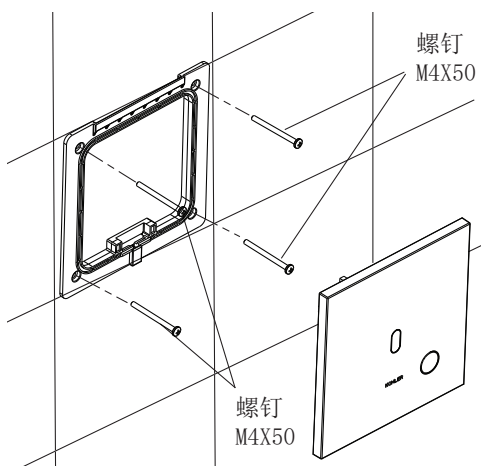

7. 分离面板和面板固定座，并按图所示拧上长螺钉以固定面板底座。

注意：面板与底座出厂时默认锁定，关于如何拆卸面板，请参照说明书“维护保养—移除面板”章节。

8. 安装面板后，观察面板是否端正及其中心线是否与座/蹲便器在一条中心线上，如有偏差，取下面板，松开固定架的锁定螺钉，调节固定架使其端正。调节后锁紧螺钉并重新装好面板。

注意：感应器的中心位置及端正与否将影响感应器正常工作。

其它形式安装

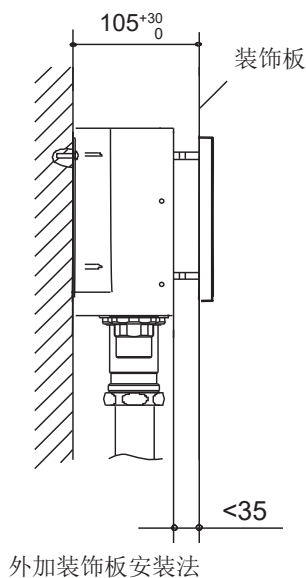
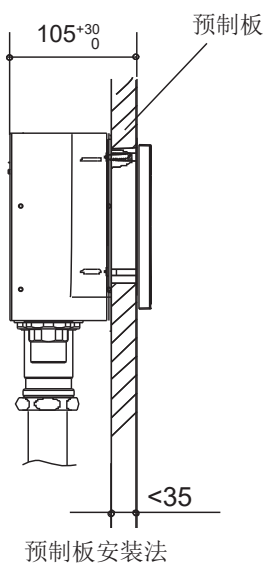

注意:以上两种安装形式，感应器的安装必须严格按尺寸图进行。

使用说明

自动调节感应范围

注意:本节操作步骤准确与否将影响感应效果。

本产品出厂时，感应距离设定为距感应窗口沿发射角度方向 $80\pm 5\text{cm}$ 以内（以 $30\text{cm}\times 30\text{cm}$ 白纸为反射平面）。接通电源2分钟内为自动调节感应范围状态，此时需要使感应器处于一个正常工作的环境内，即卫生间所有设施已安装完毕，方可操作本步骤，以便感应器准确调节感应范围。

准备工作

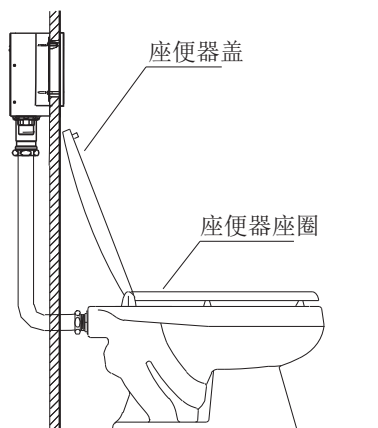

1. 放下座便器座圈，若有便器盖，请如图所示打开。
2. 移开便器周围所有杂物。

操作步骤(以下操作步骤a-d项请在5分钟内完成)

- a. 取下面板，将交流电源盒接插件与电控盒接插件连接，然后接通电源。
- b. 安装面板。
- c. 关上卫生间的门。
- d. 等待2分钟后，自动调节感应范围过程结束。

注意

- 完成以上操作步骤后，即可正常使用冲洗器。
- 从接通电到完成安装面板必须在5分钟内完成，如在5分钟内未完成，切断电源，待指示灯停止闪烁后再重新接通电源即可重复上述步骤。

冲水量设定

通电前确保感应窗口前感应区域内没有物体遮挡。

由于需要时间感应周围环境，产品上电2分钟后方可达到正常工作状态。在上电后2分钟内的感应过程中，请确保面板前感应区域内没有遮挡物。

用户可以自行设定冲水量，但设定操作需在上电后30秒内完成。如未设定，将使用默认冲水量模式1。

设定步骤

1. 上电30秒内，将控制棒贴在电控盒的右侧表面。
2. 指示灯闪烁1次为冲水量模式1，闪烁2次为冲水量模式2。设定模式2时，需在指示灯闪烁2次后快速移开控制棒。

注意

- 如超过30秒未移开控制棒进行冲水量的设定，将使用默认模式1。
- 重新上电后，模式设置不会丢失。

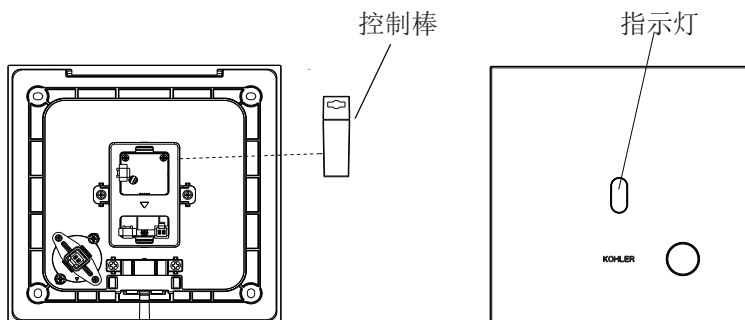

产品型号	冲水量模式 1	冲水量模式 2	冲水量模式 3
K-34176T-**	节水冲洗：4 L 普通冲洗：5.8 L	NA	NA
K-34177T-**	普通冲洗：6 L	普通冲洗：8 L	NA
K-34178T-**	节水冲洗：4 L 普通冲洗：5.8 L	NA	NA
K-34179T-**	普通冲洗：6 L	普通冲洗：8 L	NA
K-34180T-**	节水冲洗：4 L 普通冲洗：5.8 L	NA	NA
K-34181T-**	普通冲洗：6 L	普通冲洗：8 L	NA

注意

模式3为较低水压之特殊情况下使用，故未对具体冲水量进行定义。

手控冲洗

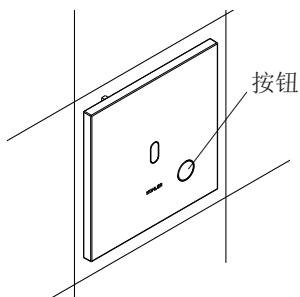

本产品对大部分衣物感应良好，但可能对极少数衣物出现感应不良现象。如有感应不良现象时，可用手控冲洗。

注意

- 此按钮仅为感应器不能正常工作或维修便器时使用，在感应器能正常工作时不建议使用。
- 当感应器不能正常工作时，请参考故障排除章节。
- 不得用力过大，以免损坏手动部件。

设备保护冲洗

便器长期处于不使用状态时，感应器将驱动电磁阀每24小时冲洗一次，以防止脱臭器及排水管干涸。

维护保养

修理便器

修理座/蹲便器时，不必拆下感应器，只需用电工胶布粘住感应窗口即可。

注意

不要用强力胶布，因为粘痕会难以清除，而产生误操作。

移除面板

1. 使用扳手推动直至闩锁松开。
2. 握住扳手，将面板底部边缘旋离墙面5~10度。然后放下扳手。
3. 抬起面板将其卸下。

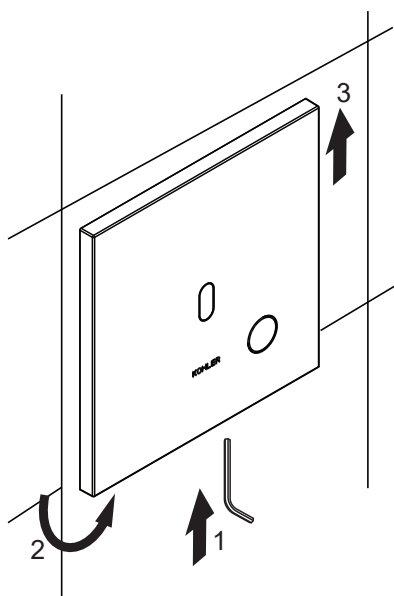

清洗过滤网

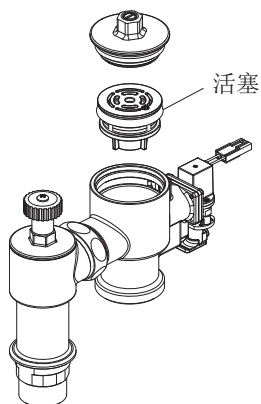

初装或使用较长时间后，如发现出水流速明显变小，且非水压原因导致，可清洗阀体中的过滤网。用活动扳手旋下固定盖，取出活塞，刷洗滤网后重新装入即可。

注意

清洗前，请先关闭水源或拧紧调节栓。

清洗时，小心取出滤网，防止杂质进入阀体内部。

清洁保养

保持感应窗口清洁，可用蘸有中性清洁剂的软布擦洗。

注意

- 禁止使用去污粉、研磨粉及油类、酸性类、碱性类清洁剂。
- 禁止直接对感应窗口喷洒空气清新剂、消毒液或其他除臭、清洁类有机溶剂。
- 避免水直接接触电线接插件。
- 请勿破坏感应窗口。

简单故障排除

请在委托修理前做以下检查：

现象	可能原因	处理方法
不出水 (感应指示灯不亮)	<ol style="list-style-type: none"> 1. 无电源或接线有误。 2. 感应范围内有其它物体一直被感应。 3. 感应窗口较脏。 4. 座便器座圈松动。 5. 座便器盖合上（若有）。 	<ol style="list-style-type: none"> 1. 检查电源连接。 2. 清理物体。 3. 清洁窗口。 4. 紧固座圈，并重新按自动调距步骤操作。 5. 打开座便盖。
感应指示灯闪烁 而无水流出或出水较差	<ol style="list-style-type: none"> 1. 调节栓未完全打开。 2. 水压太低。 3. 过滤装置脏堵。 	<ol style="list-style-type: none"> 1. 打开调节栓。 2. 改善供水情况。 3. 清洗过滤装置
不停水 感应灯也不闪烁	<ol style="list-style-type: none"> 1. 阀体部件内有脏物。 2. 手动装置损坏。 	<ol style="list-style-type: none"> 1. 清洗过滤装置后，使感应器连续感应动作数次。 2. 检查手动装置。
指示灯连续 闪烁而不出水	交流电源盒未连接或连接松脱	检查并重新接通交流电源盒

如按以上操作仍未解除故障，请通过销售商与本公司联系。

用户须知

用户责任

1. 请勿敲击感应窗口。
2. 感应器为电子器具，请勿直接用水冲洗。
3. 避免阳光或其他光源直接或反射进入感应窗口。
4. 请勿在感应器正面墙壁挂贴易反射的物体或安装光电感应器（如大便自动感应冲洗器）。
5. 请勿靠近强烈紫外线或电磁场。
6. 保持感应窗口清洁。窗口外壳可用蘸有中性清洁剂的软布擦洗。
禁止使用去污粉、研磨粉及油类、酸性类、碱性类清洁剂。
禁止直接对感应窗口喷洒空气清新剂、消毒液、或其他除臭、清洁类有机溶剂。
7. 使用水源为自来水或可供饮用井水。避免使用含有杂质较多或带有酸、碱性的处理水或未加工处理的水。
8. 将交流电源盒接入220V电源时，应采取相应的防卫措施。
9. 应确保交流导线连接处无水渗入以及不易受潮。
10. 务必在感应器安装完毕后，才向交流电源盒供电。
11. 交流电的总电源必须有合适的熔断丝加以保护。
12. 维修交流供电型的产品时，必须首先断开交流电源并关闭水源。
13. 所有电路连接必须符合相关规范和条例要求。
14. 所有参与安装人员都必须熟知安装说明。

产品中有害物质含量的说明

回收提示

本产品超过使用期限或经过维修无法正常使用后，不应随意丢弃，请交由有废弃电器电子产品处理资质的企业处理，正确的处理方法请查阅国家或当地有关废旧电器电子产品处理的规定。

有害物质统计表

部件名称	有害物质名称					
	铅 (Pb)	汞 (Hg)	镉 (Cd)	六价铬 (Cr(VI))	多溴联苯 (PBB)	多溴二苯醚 (PBDE)
外壳组件	X	○	○	○	○	○
阀体组件	X	○	○	○	○	○
控制盒组件	X	○	○	○	○	○
* 电 池 盒 组 件	○	○	○	○	○	○
* 电 池	○	○	○	○	○	○
* 交流电 源盒	○	○	○	○	○	○
* 进水组件	X	○	○	○	○	○
附件类	○	○	○	○	○	○

本表格依据SJ/T 11364-2014的规定编制

○：表示该有害物质在该部件所有均质材料中的含量均在GB/T 26572现行有效版本规定的限量要求以下。

×：表示有害物质至少在该部件的某一均质材料中的含量超出GB/T 26572现行有效版本规定的限量要求。

*：表示部分机型含有该部件。

注意：本表格提供的信息是基于供应商提供的数据及科勒公司的检测结果。本产品应用环保设计理念，在当前技术水平下，所有有害物质或元素的使用已经控制到了最低程度，科勒公司会继续努力通过改善现有技术来减少这些物质的使用。



本产品的“环保使用期限”为10年，科勒公司根据产品设计特性指定该期限。只有在本产品使用说明书所述的正常情况下使用本产品时，“环保使用期限”才有效。

kohler.com.cn

THE BOLD LOOK
OF **KOHLER**®

©2023 Kohler Co.



1535726-T2

1535726-T2-C